

new vintage **place**

## SEATING LAYOUT: Vintage Hall (includes Lounge)

Seating Capacity: 212

8-Top Round Tables +  
12-Top Head Table on Stage

Vintage Hall 2016 Rental Rates*		
Weekends (Fri & Sat)	Week Nights (Mon - Thurs)	Week Days (Mon - Fri until 2PM)
\$3,000	\$2,500	\$1,500
A/V Services Available: Add \$300		

889 Broadway Avenue NW | Grand Rapids, MI 49504  
616-774-4400 | [contact@newvintageplace.com](mailto:contact@newvintageplace.com)

Catering by West Michigan Caterer  
[westmichigancaterer.com](http://westmichigancaterer.com)

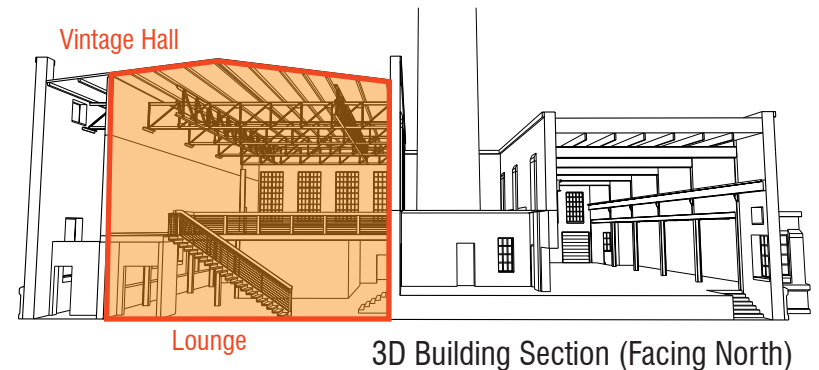

3D Building Section (Facing North)

\* Rates assume food and beverage services to be provided by West Michigan Caterer. Additional charges will apply for facility-only events.

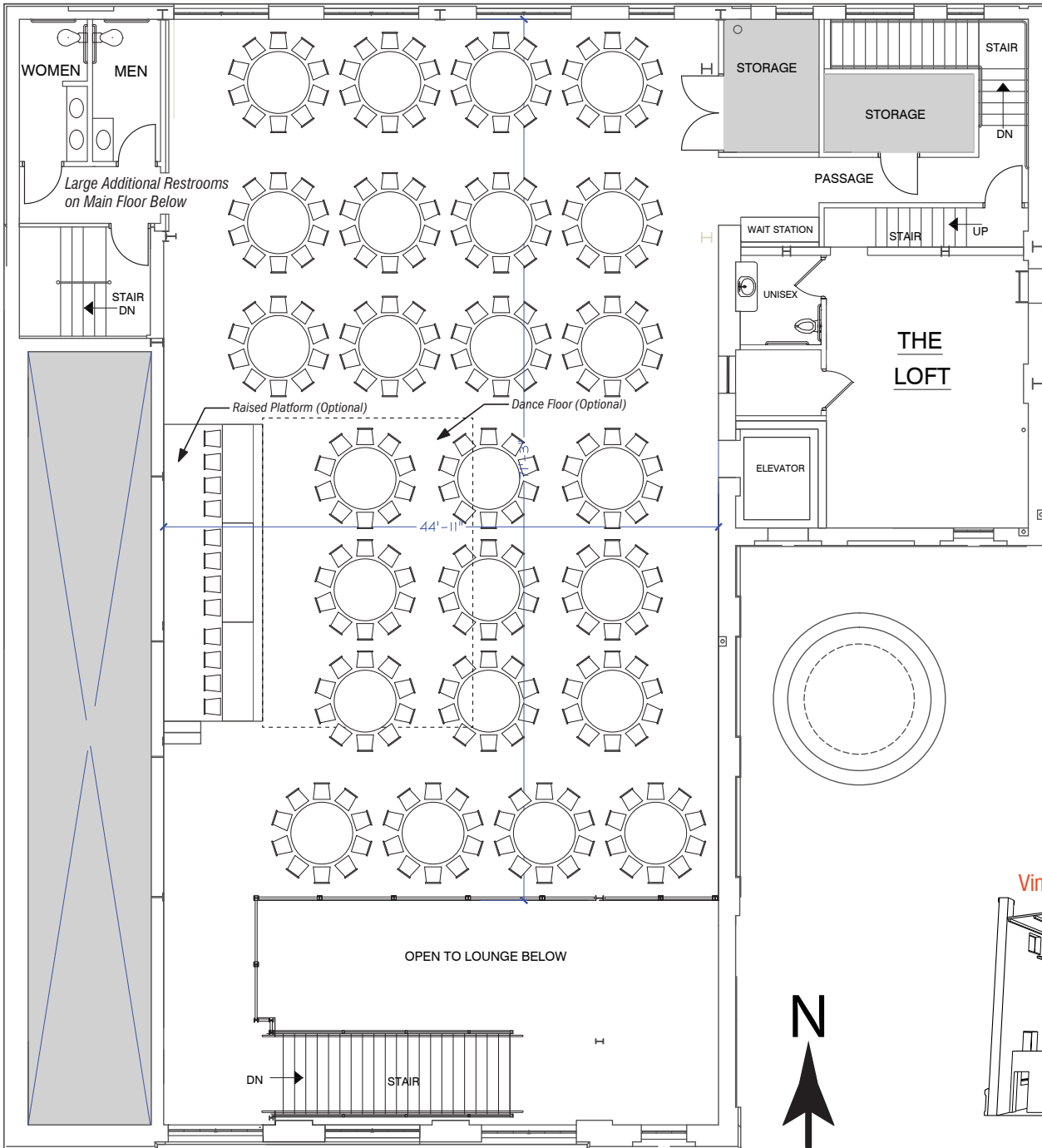

**SEATING LAYOUT:  
Vintage Hall (includes Lounge)**

**Seating Capacity: 262**

**10-Top Round Tables +  
12-Top Head Table on Stage**

Vintage Hall 2016 Rental Rates*		
Weekends (Fri & Sat)	Week Nights (Mon - Thurs)	Week Days (Mon - Fri until 2PM)
\$3,000	\$2,500	\$1,500
A/V Services Available: Add \$300		

889 Broadway Avenue NW | Grand Rapids, MI 49504  
616-774-4400 | [contact@newvintageplace.com](mailto:contact@newvintageplace.com)

Catering by West Michigan Caterer  
[westmichigancaterer.com](http://westmichigancaterer.com)

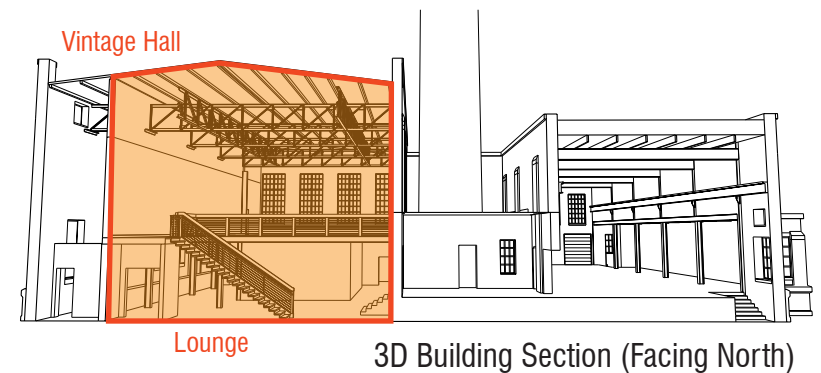

\* Rates assume food and beverage services to be provided by West Michigan Caterer. Additional charges will apply for facility-only events.